

+NOTICE!!

These documents have been scanned!

Do not place un-scanned documents beneath this notice!

Do not remove this notice from this file!

GPO Jacket No. 560-102
Print Order 61540
Rise Business Services, LLC
Job=AZ15 12:00:00 AM



Box Number= AZ15175



Claim Begin-End: AMC454409-AMC454409

1 Initial Receipt



AZ15175-40

AMC454802-AMC454539

United States Department of the Interior
Bureau of Land Management
 DIV OF LANDS, MINRLS & ENERGY
 ONE N CENTRAL AVE
 PHOENIX, AZ 85004 -4427
 Phone: 602-417-9200

Receipt

No: 4439518

Transaction #: 4558966	
Date of Transaction: 04/29/2019	
CUSTOMER:	
TIMOTHY MORRISON 31019 N 164TH DR SURPRISE, AZ 85387-6332 US	

ENTERED
 MAY -3 2019

LINE #	QTY	DESCRIPTION	REMARKS	UNIT PRICE	TOTAL
1	1.00	LOCATABLE MINERALS / MINING CLAIMS-NEW, UNADJUD, ONE OR MORE AUTH NOS / NEW MINING CLAIM PROCESSING FEE CASES: AMC454409/\$20.00		- n/a -	20.00
2	1.00	LOCATABLE MINERALS / MINING CLAIMS-NEW, UNADJUD, ONE OR MORE AUTH NOS / NEW MINING CLAIMS LOCATION FEE CASES: AMC454409/\$37.00		- n/a -	37.00
3	1.00	LOCATABLE MINERALS / MINING CLAIMS-NEW, UNADJUD, ONE OR MORE AUTH NOS / NEW MINING CLAIMS MAINTENANCE FEE CASES: AMC454409/\$155.00		- n/a -	155.00
TOTAL:					\$212.00

PAYMENT INFORMATION			
NOTE: Items will appear on credit card statement as "Bureau of Land Mgmt CO".			
1	AMOUNT:	212.00	POSTMARKED: N/A
	TYPE:	CREDIT CARD	RECEIVED: 04/29/2019
	NAME:	MORRISON, TIMOTHY 31019 N 164TH DR SURPRISE AZ 85387-6332 US	
	CARD NO:	XXXXXXXXXXXX2091	AUTH CODE: 225900
	NAME ON CARD:	TIMOTHY J MORRISON	
	SIGNATURE:		

REMARKS

This receipt was generated by the automated BLM Collections and Billing System and is a paper representation of a portion of the official electronic record contained therein.

NOTICE!!

These documents have been scanned!

Do not place un-scanned documents beneath this notice!

Do not remove this notice from this file!

GPO Jacket No. 560-102
Print Order 61540
Rise Business Services, LLC
Job=AZ15 12:00:00 AM



Box Number= AZ15175



Claim Begin-End: AMC454409-AMC454409

2 Correspondence



AZ15175-40

AMC454802-AMC454539

**NO
DOCUMENTS
FOUND**

NO DOCUMENTS FOUND
NO DOCUMENTS FOUND

NOTICE!!

These documents have been scanned!

Do not place un-scanned documents beneath this notice!

Do not remove this notice from this file!

GPO Jacket No. 560-102
Print Order 61540
Rise Business Services, LLC
Job=AZ15 12:00:00 AM



Box Number= AZ15175



Claim Begin-End: AMC454409-AMC454409

3 Transfers



AZ15175-40

AMC454802-AMC454539

Recorded at the request of:



When Recorded, MAIL TO:

454409

See pg 2

Quit claim Deed

RECORDED
COUNTY CLERK
2020 MAY 11 A 8:19
PHOENIX ARIZONA

ENTERED
MAY 14 2020
BY: Ban

4734208

Prepared By

Name: Jennifer Tokarski
Address: 17031 W Central St
Surprise
State: Arizona Zip Code: 85388

After Recording Return To

Name: Jennifer Tokarski
Address: 17031 W Central St
Surprise
State: Arizona Zip Code: 85388

Space Above This Line for Recorder's Use

ARIZONA QUIT CLAIM DEED

STATE OF ARIZONA

Yavapai COUNTY

PHOENIX, ARIZONA
2020 MAY 11 A 8:36
RECEIVED
DEPUTY STATE CLERK

KNOW ALL MEN BY THESE PRESENTS, That for and in consideration of the sum of TWO THOUSAND DOLLARS (\$ 2,000.00) in hand paid to TIMOTHY MORRISON, a CITIZEN, residing at 31019 N 164TH DR., County of MARICOPA, City of SURPRISE, State of AZ (hereinafter known as the "Grantor(s)") hereby conveys and quitclaims to Jennifer Tokarski, a CITIZEN, residing at 17031 W CENTRAL ST, County of maricopa, City of Surprise, State of Arizona (hereinafter known as the "Grantee(s)") all interest which I (we) have, if any in the following described real estate, situated in Yavapai County, Arizona to-wit:

for legal description see attached document "A"

✓ AMC454409

A6 [INSERT LEGAL DESCRIPTION HERE OR ATTACH AND INSERT]

To have and to hold, the same together with all and singular the appurtenances thereunto belonging or in anywise appertaining, and all the estate, right, title, interest, lien, equity and claim whatsoever for the said first party, either in law or equity, to the only proper use, benefit and behoof of the said second party forever.

Timothy J. Morrison
Grantor's Signature

TIMOTHY J. MORRISON
Grantor's Name

31019 N 164th DR.
Address

SURPRISE AZ 85387
City, State & Zip

Grantor's Signature

Grantor's Name

Address

City, State & Zip

STATE OF ARIZONA)

COUNTY OF Maricopa)

I, the undersigned, a Notary Public in and for said County, in said State, hereby certify that David Klein whose names are signed to the foregoing instrument, and who is known to me, acknowledged before me on this day that, being informed of the contents of the instrument, they, executed the same voluntarily on the day the same bears date.

Given under my hand this 6th day of April, 2020
[Signature]
Notary Public

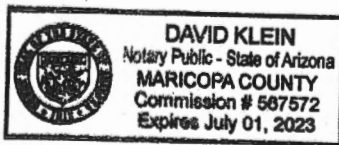

My Commission Expires: 7-1-23

RECEIVED
DEPT. OF STATE OFFICE
2020 MAY 11 A 8:14
PHOENIX, ARIZONA

Attachment "A"

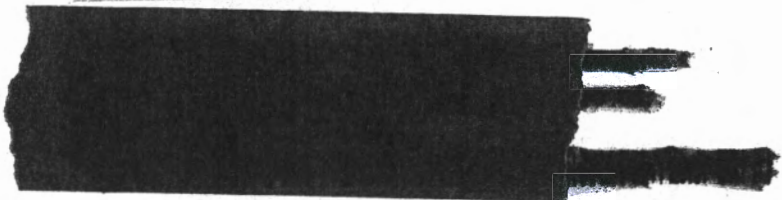

LOCATION NOTICE FOR PLACER MINING CLAIM

Amendment BLM Serial # _____

NOTICE IS HEREBY GIVEN that the LADY J placer mining claim has been located by

TIMOTHY MORRISON

whose current mailing address is:

31019 N 164 TH DR

SURPRISE AZ 85387

BLM Date Stamp
2019 APR 29 P 1:40
PHOENIX, ARIZONA

RECEIVED
BLM AZ STATE OFFICE

The general course of this claim is **East to West** and it is situated in **Yavapai** County, Arizona. This claim is **1320** feet in length and **660** feet in width.

20 Total Claim Acreage. This claim runs from the location monument on which this location notice is posted at the **NE** corner of the claim approximately **1320** feet in a **West** direction to the **West** end line and **660** feet in a **South** direction to the **South** end line. This claim is marked by four monuments, one at each corner of the claim. The location monument on which this notice is posted is situated within Section **1**, Township **11N** Range **1W**, Gila Salt River Base and Meridian, Arizona. This claim encompasses portions of the following legal subdivision(s) if located by legal subdivision or the following quarter section(s), section(s), Township(s) and Range(s) S 1/2 of the SW 1/4 of the SE 1/4 of Section 1 Township 11N Range 1W, Gila Salt River Base and Meridian, Arizona. The locality of this claim with reference to some natural object or permanent monument and additional information (if any) concerning its locality are as follows: The SE corner of this claim is located 1320' West of the SE corner of Section 1 Township 11N Range 1W Gila Salt River Base and Meridian, Arizona.

AMC454409

The above information is shown on the attached map. DATED AND POSTED on the ground this 8 day of Feb, 2019.

Claimants:

Printed Name TIMOTHY J. MORRISON Signature(s) [Signature]

address: 31019 N 164 DR SURPRISE AZ 85387

Printed Name _____ Signature(s) _____

address: _____

RECEIVED
BLM AZ STATE OFFICE
2019 MAY 11 A 8:19
PHOENIX, ARIZONA

Attachment "A"

MINING CLAIM MAP

Lode () Placer ()
Millsite ()

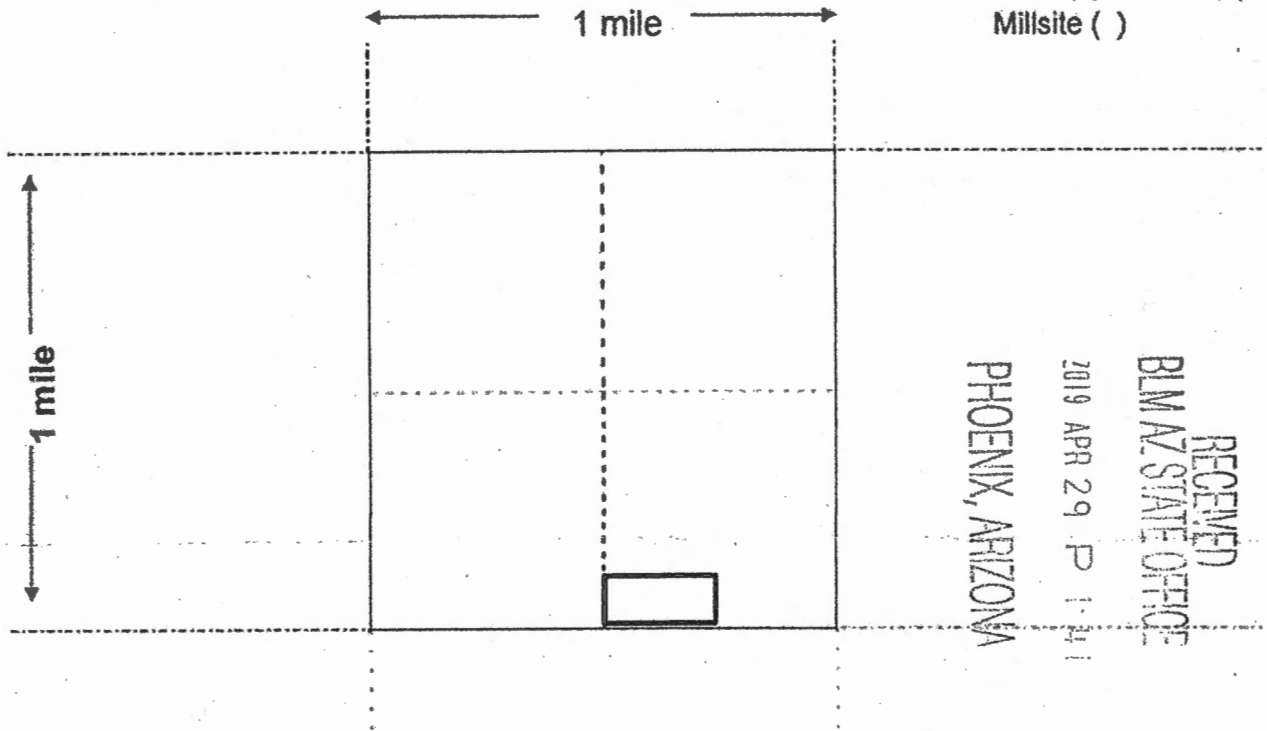

RECEIVED
BIMAZ STATE OFFICE
2019 APR 29 P 1:41
PHOENIX, ARIZONA

Scale: 1" = 2000 feet



RECEIVED
BIMAZ STATE OFFICE
2020 MAY 11 A 8:17
PHOENIX, ARIZONA

1. The above map depicts the LADY J mining claim, which is located in Section 1, Township 11N, Range 1W, Gila and Salt River Base and Meridian, Yavapai County, Arizona.

Total claim acreage is 20.

2. The type of corner and location monuments used are as follows: 4' capped PVC

3. The bearings and distances in degrees and feet between claim corners and to a public land survey monument are as depicted on the map. The SE corner of this claim is located 1320

West of the SE corner of Section 1 Township 11N Range 1W Gila Salt River Base and Meridian, Arizona.

4. If the claim is a placer or millsite claim with exterior limits conforming to legal subdivisions of the public survey, provide a legal description of the claim S 1/2 of the SW 1/4 of the SE 1/4 of Section 1 Township 11N Range 1W Gila Salt River Base and Meridian, Arizona.

This form is available from the Arizona Geology Survey and may be reproduced.

AMC454409

Jennifer Tokarski
17031 W. Central St
Surprise Az 85388

PHOENIX
AZ 852
06 MAY '20
PM 9 L

\$0.65⁰
US POSTAGE
FIRST-CLASS
071V01330105
85374
002162952



RECEIVED
BLM STATE OF ARIZ
2020 MAY 11 A 8:17
PHOENIX, ARIZONA

Attn. Accounts BLM
1 N. Central Ave # 800
Phoenix AZ 85004

85004-442700



United States Department of the Interior
Bureau of Land Management
 DIV OF LANDS, MINRLS & ENERGY
 ONE N CENTRAL AVE
 PHOENIX, AZ 85004 -4427
 Phone: 602-417-9200

Receipt	
No:	4734208

Transaction #: 4860112	
Date of Transaction: 05/11/2020	
CUSTOMER:	
JENNIFER TOKARSKI 17031 W CENTRAL ST SURPRISE, AZ 85388-1513 US	

LINE #	QTY	DESCRIPTION	REMARKS	UNIT PRICE	TOTAL
1	1.00	LOCATABLE MINERALS / MINING CLAIMS- NOT NEW-UNADJUD, ONE AUTH NO. ONLY / MINING CLAIM MONEY RECEIVED CASES: AMC454409/\$15.00	TRF	- n/a -	15.00
TOTAL:					\$15.00

PAYMENT INFORMATION			
1	AMOUNT:	15.00	POSTMARKED: N/A
	TYPE:	CHECK	RECEIVED: 05/11/2020
	CHECK NO:	R208876413581	
	NAME:	TOKARSKI, JENNIFER 17031 W CENTRAL ST SURPRISE AZ 85388-1513 US	

REMARKS

This receipt was generated by the automated BLM Collections and Billing System and is a paper representation of a portion of the official electronic record contained therein.

**NO
DOCUMENTS
FOUND**

NO DOCUMENTS FOUND
NO DOCUMENTS FOUND

NOTICE!!

These documents have been scanned!

Do not place un-scanned documents beneath this notice!

Do not remove this notice from this file!

GPO Jacket No. 560-102
Print Order 61540
Rise Business Services, LLC
Job=AZ15 12:00:00 AM



Box Number= AZ15175



Claim Begin-End: AMC454409-AMC454409

4 Annual Filings



AZ15175-40

AMC454802-AMC454539

DEPARTMENT OF THE INTERIOR
BUREAU OF LAND MANAGEMENT
MINING CLAIMS

Run Date/Time: 9/5/2019

MC Maintenance Fees Paid Through the BLM Pay Portal
(by Date Paid)

Page 370 Of 521

CBS Receipt: 4549559

Printed For Lead File # AMC454409

Agency Tracking ID: 1567186488

Assessment Year: 2020

Number of BLM Serial Nr: 1

Paid On: 8/30/2019

Total Amount Paid: \$165.00

Claim Name	BLM Serial No	Lead File No	Amount Paid
LADY J	AMC454409	AMC454409	\$165.00

United States Department of the Interior
Bureau of Land Management
 BUSINESS & SUPPORT SVCS DIV
 ONE N CENTRAL AVE SUITE 800
 PHOENIX, AZ 85004 -4427
 Phone: 602-417-9200

Receipt	
No:	4549559

Transaction #: 4670589	
Date of Transaction: 08/30/2019	
CUSTOMER:	
TIMOTHY MORRISON 31019 N 164TH DR SURPRISE, AZ 85387 US	

LINE #	QTY	DESCRIPTION	REMARKS	UNIT PRICE	TOTAL
1	1.00	LOCATABLE MINERALS / MINING CLAIMS- NOT NEW-UNADJUD, ONE AUTH NO. ONLY / MINING CLAIM MONEY RECEIVED CASES: AMC454409/\$165.00		- n/a -	165.00
TOTAL:					\$165.00

PAYMENT INFORMATION			
NOTE: Items will appear on credit card statement as "BLM O Mining Claim".			
1	AMOUNT:	165.00	POSTMARKED: N/A
	TYPE:	CREDIT CARD	RECEIVED: 08/30/2019
	NAME:	TIMOTHY MORRISON 31019 N 164TH DR SURPRISE AZ 85387 US	
	CARD NO:	XXXXXXXXXXXX2091	AUTH CODE: 143340
	NAME ON CARD:	TIMOTHY MORRISON	
	SIGNATURE:	INTERNET	

REMARKS

This receipt was generated by the automated BLM Collections and Billing System and is a paper representation of a portion of the official electronic record contained therein.

NOTICE!!

These documents have been scanned!

Do not place un-scanned documents beneath this notice!

Do not remove this notice from this file!

GPO Jacket No. 560-102
Print Order 61540
Rise Business Services, LLC
Job=AZ15 12:00:00 AM



Box Number= AZ15175



Claim Begin-End: AMC454409-AMC454409

5 Miscellaneous



AZ15175-40

AMC454802-AMC454539

**NO
DOCUMENTS
FOUND**

NO DOCUMENTS FOUND
NO DOCUMENTS FOUND

NOTICE!!

These documents have been scanned!

Do not place un-scanned documents beneath this notice!

Do not remove this notice from this file!

GPO Jacket No. 560-102
Print Order 61540
Rise Business Services, LLC
Job=AZ15 12:00:00 AM



Box Number= AZ15175



Claim Begin-End: AMC454409-AMC454409

6 Location Notices-Amendments and Supporting Documents



AZ15175-40 AMC454802-AMC454539

Mining Claim Status Report

Data Entered: 5/3/2019

MTP Checked By: YMC
GEO Checked By: down

LEAD SERIAL NUMBER: AMC 454409 thru AMC _____

NUMBER OF CLAIMS & TYPE:

_____/_____/_____/_____/_____
LODE
PLACER
ASSOCIATION PLACER
MILL SITE
TUNNEL SITE

CHARGES:

Processing Fee @ \$20 = \$ 20
Location Fee @ \$37 = \$ 37
Maintenance Fee @ \$155 = \$ 155
Add'l Maint Fee for Assoc Placer = \$ _____
SUBTOTAL \$ _____
Other Fees \$ _____
Other Fees \$ _____
TOTAL \$ 212

TOTAL ACREAGE: 20 Per Claim
(Placer Only)

NUMBER OF LOCATORS: _____

DOCUMENTS RECEIVED VIA: Over-the-Counter Mail TIMELY FILED: Yes No

LEGAL DESCRIPTION: T 11N R 1W SEC 1
T _____ R _____ SEC _____
T _____ R _____ SEC _____
T _____ R _____ SEC _____
T _____ R _____ SEC _____

BLM FOREST SERVICE Prescott SUBJ TO PL 359: Yes No
WILDERNESS AREA

SPLIT ESTATE: N/A SX PX OTHER
SRHA Was proper Notice filed if located on SHRA Land? Yes No

RECONVEYED MINERALS ON BLM LAND REQUIRE OPENING ORDER FROM 1944 TO 1993:
Open to Entry On _____ N/A

COMMENTS/STATUS: VOID PARTIALLY VOID PVT MINERALS WITHDRAWN LANDS
OTHER

[] Claimant acknowledges that portions of the following claim(s) site(s) may be void or voidable.

Printed Name of Claimant _____ Signature of Claimant _____

*****FINAL ADJUDICATION*****

DATE _____ INITIALS _____

AMC454409



LOCATION NOTICE FOR PLACER MINING CLAIM

Amendment BLM Serial # _____

NOTICE IS HEREBY GIVEN that the LADY J
placer mining claim has been located by
TIMOTHY MORRISON
whose current mailing address is:
31019 N 164 TH DR
SURPRISE AZ 85387

RECEIVED
BLM AZ STATE OFFICE
PHOENIX, ARIZONA
2019 APR 29 P 1:40
BLM
Date
Stamp

The general course of this claim is **East to West** and it is situated in **Yavapai** County, Arizona. This claim is **1320** feet in length and **660** feet in width.

20 Total Claim Acreage. This claim runs from the location monument on which this location notice is posted at the **NE** corner of the claim approximately **1320** feet in a **West** direction to the **West** end line and **660** feet in a **South** direction to the **South** end line. This claim is marked by four monuments, one at each corner of the claim. The location monument on which this notice is posted is situated within Section **1**, Township **11N** Range **1W**, Gila Salt River Base and Meridian, Arizona. This claim encompasses portions of the following legal subdivision(s) if located by legal subdivision or the following quarter section(s), section(s), Township(s) and Range(s) S 1/2 of the SW 1/4 of the SE 1/4 of Section 1 Township 11N Range 1W, Gila Salt River Base and Meridian, Arizona. The locality of this claim with reference to some natural object or permanent monument and additional information (if any) concerning its locality are as follows: The SE corner of this claim is located 1320' West of the SE corner of Section 1 Township 11N Range 1W Gila Salt River Base and Meridian, Arizona.

AMC454409

The above information is shown on the attached map. DATED AND POSTED on the ground this 8 day of Feb, 2019.

Claimants:

Printed Name TIMOTHY J MORRISON Signature(s) Timothy Morrison
address: 31019 N 164 DR SURPRISE AZ 85387

Printed Name _____ Signature(s) _____
address: _____

MINING CLAIM MAP

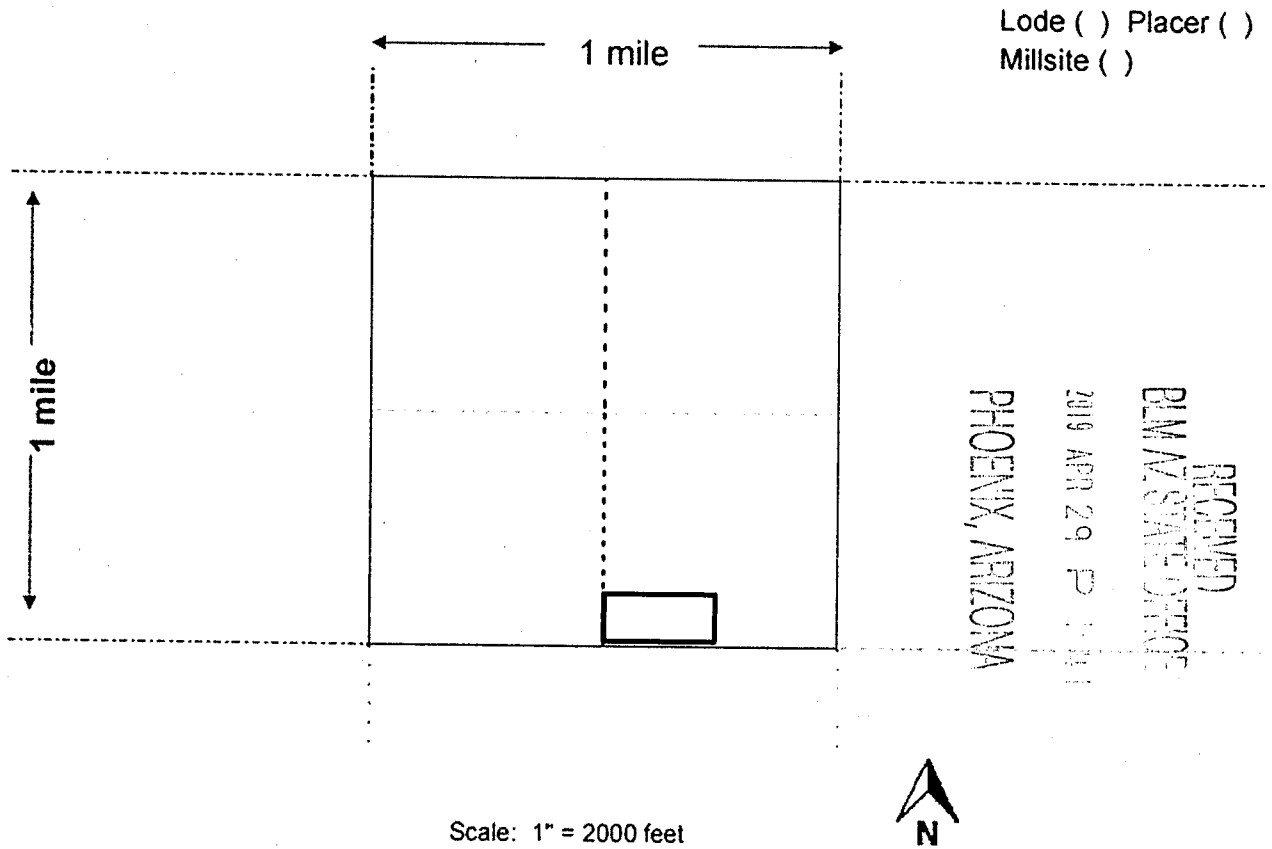

1. The above map depicts the LADY J mining claim, which is located in Section 1, Township 11N, Range 1W, Gila and Salt River Base and Meridian, Yavapai County, Arizona.

Total claim acreage is 20.

2. The type of corner and location monuments used are as follows: 4' capped PVC

3. The bearings and distances in degrees and feet between claim corners and to a public land survey monument are as depicted on the map. The SE corner of this claim is located 1320

West of the SE corner of Section 1 Township 11N Range 1W Gila Salt River Base and Meridian, Arizona.

4. If the claim is a placer or millsite claim with exterior limits conforming to legal subdivisions of the public survey, provide a legal description of the claim S 1/2 of the SW 1/4 of the SE 1/4 of Section 1 Township 11N Range 1W, Gila Salt River Base and Meridian, Arizona.

This form is available from the Arizona Geology Survey and may be reproduced.

AMC454409

LR2K Home CR-24



LR2000 Internal

CR Geographic Report with Land

[Download User Guide \(pdf\)](#)

Purpose: This report produces a geographic listing of case information based on retrieval by Meridian/Township/Range. This report format will display the case type, case disposition, meridian, township, range, section, survey type, survey number, surface management agency, pending actions, serial number, and total case acres.

To refresh the query, do a **Ctrl-R**. It resets the page and clears any criteria fields that may have entries.



No Results

The specified criteria didn't result in any data. This is often caused by applying filters and/or selection steps that are too restrictive or that contain incorrect values. Please check your analysis filters and selection steps, and try again. The filters or selection steps currently being applied are shown below.

Filters

Disposition is equal to **AUTHORIZED, CANCELLED, EXPIRED, PENDING, REJECTED, RELINQUISHED, WITHDRAWN**
and Meridian Township Range Section is equal to **14 0110N 0010W 001**
and Admin State is equal to **AZ**

[Return](#) - Refresh

UNSURVEYED TOWNSHIP 11 NORTH RANGE 1 WEST OF THE GILA AND SALT RIVER MERIDIAN, ARIZONA

PROTRACTION DIAGRAM NO 16 OFFICIALLY FILED 12/07/1959

YAVAPAI COUNTY
HASSAYAMPA FIELD OFFICE

STATUS OF PUBLIC DOMAIN
LAND AND MINERAL TITLES

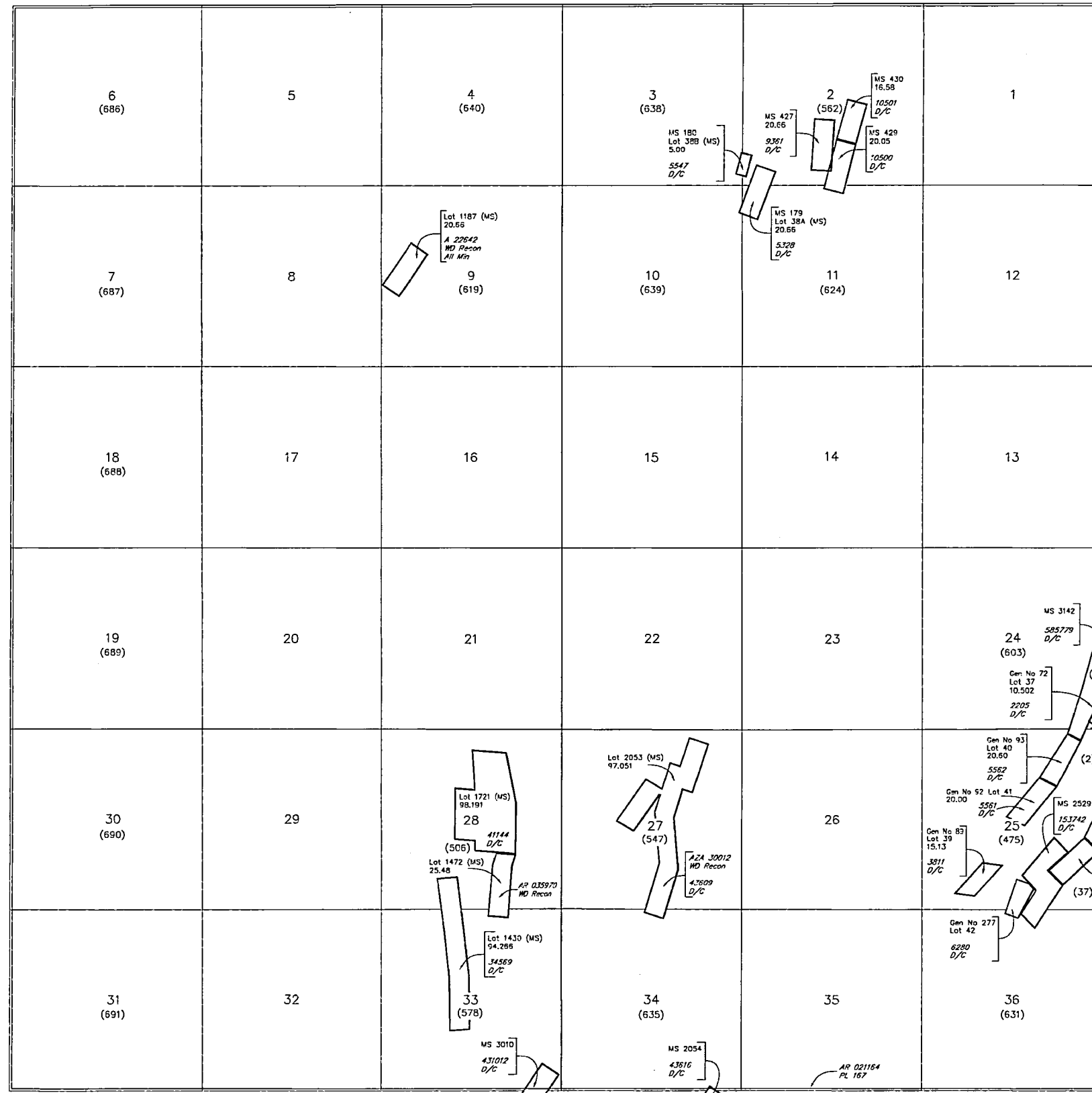

INDEX TO SEGREGATED TRACTS					
RESURVEY		ORIGINAL SURVEY			
TRACT NO	T	R	SEC	SUBDIVISION	

FOR ORDERS AFFECTING DISPOSAL OR USE OF UNIDENTIFIED LANDS WITHDRAWN FOR CLASSIFICATION, MINERALS, WATER AND/OR OTHER PUBLIC PURPOSES, REFER TO INDEX OF MISCELLANEOUS DOCUMENTS.

*MDS 214 NE
215 NW
216 SW
217 SE*

All Tp included in Wd Prescott NF Proc 6 10/21/1899

NOTE - Mineral surveys MS 180, MS 427, MS 429, MS 430, MS 179, Lot 1721 (MS), Lot 1472 (MS) and Lot 1430 (MS) have been remapped using updated survey ties. The acreages in affected protracted sections have been estimated to reflect mineral survey relocations.

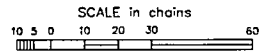

WARNING STATEMENT
This plot is the Bureau's Record of Title, and should be used only as a graphic display of the Township survey data. Records herein do not reflect title changes which may have been affected by lateral movements of rivers or other bodies of water. Refer to the cadastral surveys for official survey information.

CURRENT TO	JK	GSR Mer
12-11-2008	ACAD	T 11 N
		R 1 W